

Atkore[™]
Unistrut[®]

**Atkore Unistrut
Catalogue**

Electrical & Mechanical Support Systems

**Mechanical/
Pipe Support**



ATKORE UNISTRUT

The Original Metal Framing System

Unistrut is the original metal framing system, featuring a unique weldless connection. The Unistrut system eliminates welding and drilling, and is easily adjustable and reusable for infinite configurations. Since 1924, our brand has evolved from a simple connection concept to a comprehensive engineered building and support system featuring a robust line of channels, fittings, fasteners, hangers, pipe clamps cable trays and cable ladders. Backed by our worldwide network of engineering and distribution centres, we provide customers with total-resource capability, making Unistrut the brand everyone asks for by name.



Allied Tube & Conduit ▲ AFC Cable Systems ▲ Heritage Plastics ▲ Unistrut
Unistrut Construction ▲ United Poly Systems ▲ Calbrite ▲ Calbond ▲ Cii ▲ US Tray
Power-Strut ▲ Calconduit ▲ Razor Ribbon ▲ Calpipe Security ▲ Vergokan ▲ Marco
Columbia-MBF ▲ Eastern Wire + Conduit ▲ ACS/Uni-Fab ▲ Sasco Strut ▲ Kaf-Tech
Cope ▲ FRE Composites ▲ Queen City Plastics ▲ Four Star Industries ▲ Flexicon



Introduction



The Atkore Unistrut World of Support starts with our network of Unistrut Service Centers across the nation.

Atkore Unistrut World of Support starts with our network of Unistrut Service Centres throughout New Zealand. They go far beyond providing local product inventories, by offering complete application solutions, based on experience gained from thousands of projects worldwide. It's the kind of knowledgeable assistance that can help save time and cost now, and simplify change in the future.

Technical help? No one knows the engineering side of Unistrut support systems like your local Atkore Unistrut team. If it's special fabrication, cutting or custom finishing you want, the pros at your local Unistrut Service Centre will make it happen - quickly, efficiently, economically. So when it's help you need, call your Unistrut Service Centre - the quickest way to unlock Atkore Unistrut's World of Support.

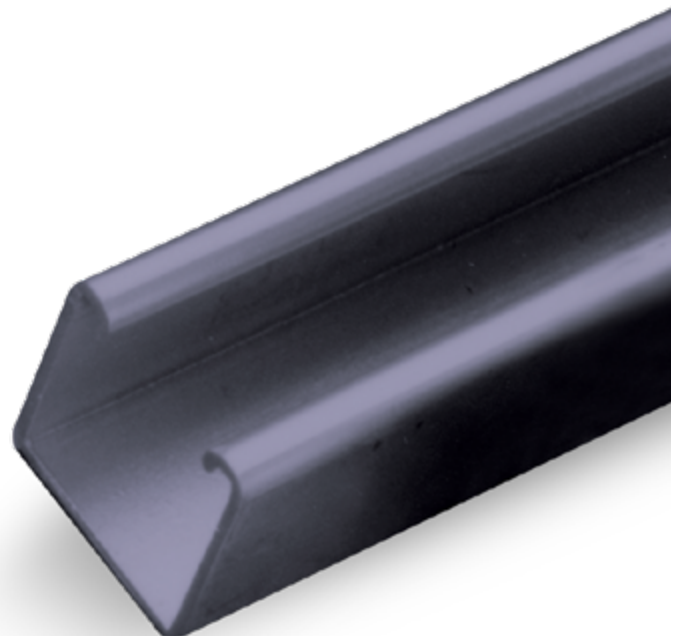



Atkore Unistrut New Zealand

Atkore Unistrut has been the leading supplier of metal framing systems for over 45 years.

We specialise in Metal Framing, Cable Management and our products and services are synonymous with engineering excellence and reliability worldwide.

Over Ninety Years Of Innovation

Unistrut began developing and manufacturing products during the 1920s, producing the original Unistrut® Metal Framing System. Our extensive product portfolio now includes a variety of cable management solutions and advanced metal framing systems.

Sharing our Experience, Knowledge and Expertise

We continue to make investments in our people, products and services. Our ability to share our experience and knowledge with our customers is the key to our success in a wide range of industry sectors.

Proven Delivery Processes

Atkore Unistrut has proven procedures that guarantee the delivery of orders.

Part of the Atkore® Family

Atkore is a major manufacturer and innovator with a unique focus on steel frame, pipe and electrical products. As part of the Atkore family, we can draw on a variety of technologies, products and experience from Atkore companies throughout the world.



Introduction

Wide Range of Applications for Construction and Industry

Atkore Unistrut can supply a wide variety of standard structural fittings in zinc plated heavy duty galvanised, aluminium and 316 stainless steel. Atkore Unistrut engineers can also design specialised fittings for individual project needs.

With resources across the Asia Pacific region, including manufacturing sites in New Zealand and Asia totaling over 400,000m² in floor space accredited to ISO9001.

Atkore Unistrut facilities have automated welding, over 30 metal pressing machines, from 16 to over 300 tonnes, and roll forming machinery. Services from both our Atkore Unistrut fully owned operations and our JV partner facilities can fully label, pack and ship to your individual specifications. Marshalling and packaging is done in-house and from our manufacturing facility fully undercover.

Projects in the Region Successfully Supplied Include

- Waterview Tunnel Project
- M2pp Bridge Services
- Mount Victoria Tunnel Services (Fire And Seismically Rated)
- Christchurch Hospital
- Kaimai Rail Tunnel Service Supports
- Pacific Island Standby Power Systems
- Darfield Dryers Service Support Systems
- City rail link
- Auckland Library Granite Cladding Support System

Atkore Overview

- Revenue of \$1.8B
- 3,100+ employees
- 27 manufacturing and service locations in New Zealand, Asia Pacific, EMEA and North America
- Strong brands that are well known by customers and respected in the industry
- Purchase & process close to one million tonne of steel per year – approximately 50,000 truckloads
- Produce enough electrical cable each year to circle the earth 7 times
- Electrical Raceway and Mechanical Products solutions



Pipe Supports - Pictorial Index

Pipe Supports

The Unistrut® pipe support systems covers an extensive range of hangers, pipe clips, pipe clamps ferrules and cushioning, hanger fittings, beam clamps, beam attachments, and support brackets. The range covers from small bore tubing through to pipes in excess of 600mm diameter.

Sprinkler Pipe Supports

In addition to our standard range of pipe supports for general industry, mechanical services and others, the Unistrut® range also includes pipe supports specifically designed for the fire protection industry.

Pipe Supports - Light Duty

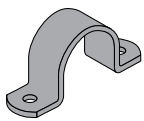

UN4
LIGHT DUTY PIPE
CLAMPS
PG. 154



UN6
LIGHT DUTY
TWO-PIECE
PIPE CLAMPS
PG. 154



UN8
LIGHT DUTY
TWO-PIECE
PIPE CLAMPS
PG. 155

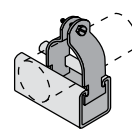

P2024
PIPE SUPPORTS
PG. 156

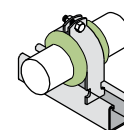

P2600
UNI-CUSHION
PG. 156

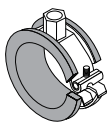

WOPF STANDARD
SINGLE BOLT CLIP
(INSULATED)
PG. 154

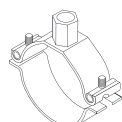

WOPF PERFECT
2 BOLT CLIP
PG. 157



WOPF STANDARD
2 BOLT CLIP
(INSULATED)
PG. 157

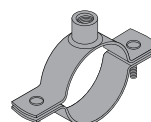

SPLIT CLIPS
PG. 158

Pipe Supports - Medium Duty

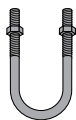

UN14
"U" BOLTS
PG. 159

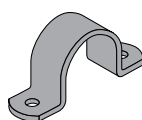

UN15
MEDIUM DUTY
SADDLE CLAMP
PG. 159



UN16
MEDIUM DUTY
TWO-PIECE
PIPE CLAMPS
PG. 160



UN18
MEDIUM DUTY
TWO-PIECE
PIPE CLAMP
PG. 161



UN20
MEDIUM DUTY
THREE BOLT
PIPE CLAMP
PG. 161

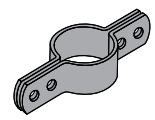

UN21
MEDIUM DUTY
VERTICAL PIPE CLAMP
PG. 161

Pipe Supports - Heavy Duty And Accessories

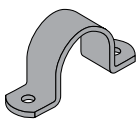

UN30
HEAVY DUTY
SADDLE CLAMP
PG. 162



UN31
HEAVY DUTY
TWO-PIECE PIPE CLAMP
PG. 162

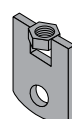

UN35
EYE NUTS [HG]
PG. 162

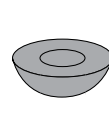

UN37
SPHERICAL WASHER
FOR UN38 [M]
PG. 163

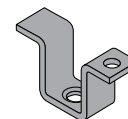

UN38
SWIVEL CAGE [HG]
PG. 163

Accessories And Beam Attachments

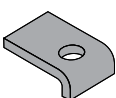

UN44
BEAM CLIP
PG. 164



UNCL
CLEVIS HANGER
[HG]
PG. 164



UNPL
LINK PLATE [HG]
PG. 164

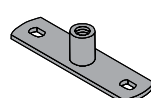

EF1200
ROD HANGER
MOUNTING PLATES
PG. 165

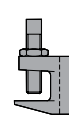

EF1600
FLANGE CLAMP
PG. 165

Pipe Supports – Light Duty

UN4 – Light Duty Pipe Clamps

- Working Load: 0.75 kN
- Safety Factor: 2.5
- Standard Finish: Heavy Duty Galvanised

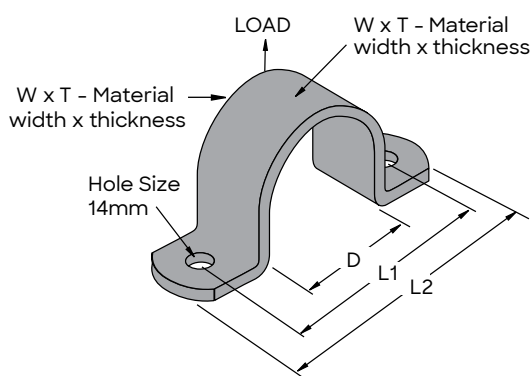

Part No.	D	W x T	L1 mm	L2 mm	kg
UN4-016	16	25x3	56	80	0.04
UN4-019	19	25x3	59	83	0.04
UN4-021	21	25x3	61	85	0.05
UN4-025	25	25x3	65	89	0.06
UN4-027	27	25x3	67	91	0.07
UN4-032	32	25x3	72	96	0.07
UN4-034	34	25x3	74	98	0.08
UN4-038	38	25x3	78	102	0.08
UN4-043	43	25x3	83	107	0.08
UN4-048	48	25x3	88	112	0.09
UN4-051	51	25x3	91	115	0.09
UN4-060	60	25x3	100	124	0.12
UN4-064	64	25x3	104	128	0.12
UN4-073	73	25x3	113	137	0.12
UN4-076	76	25x3	116	140	0.14
UN4-089	89	25x3	129	153	0.16
UN4-095	95	25x3	135	159	0.17
UN4-102	102	25x3	142	166	0.18
UN4-114	114	25x3	154	178	0.18

UN6 – Light Duty Two-Piece Pipe Clamps

- Working Load: 2.88 kN
- Safety Factor: 2.5
- Standard Finish: Heavy Duty Galvanised

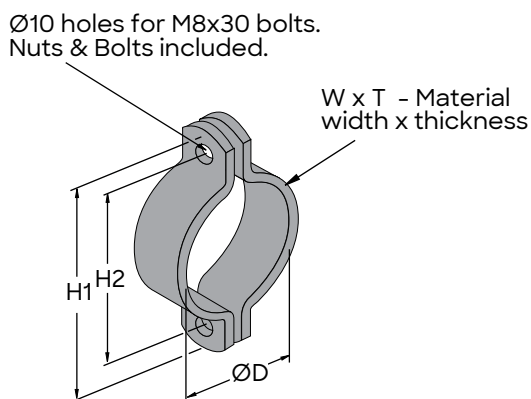

Part No.	ØD	W x T	H1 mm	H2 mm	kg
UN6-019	19	25x3	83	59	0.10
UN6-021	21	25x3	85	61	0.10
UN6-025	25	25x3	89	65	0.11
UN6-027	27	25x3	91	67	0.11
UN6-032	32	25x3	96	72	0.14
UN6-034	34	25x3	98	74	0.14
UN6-038	38	25x3	102	78	0.15
UN6-043	43	25x3	107	83	0.15
UN6-048	48	25x3	112	88	0.15
UN6-051	51	25x3	115	91	0.15
UN6-060	60	25x3	124	100	0.15
UN6-064	64	25x3	128	104	0.19
UN6-073	73	25x3	137	113	0.19
UN6-076	76	25x3	140	116	0.19
UN6-089	89	25x3	153	129	0.21
UN6-102	102	25x3	166	142	0.23
UN6-114	114	25x3	178	154	0.26
UN6-127	127	25x3	191	167	0.28
UN6-140	140	25x3	204	180	0.31
UN6-152	152	25x3	216	192	0.33
UN6-165	165	25x3	229	205	0.37

Pipe Supports – Light Duty

UN8 – Light Duty Two-Piece Pipe Clamps

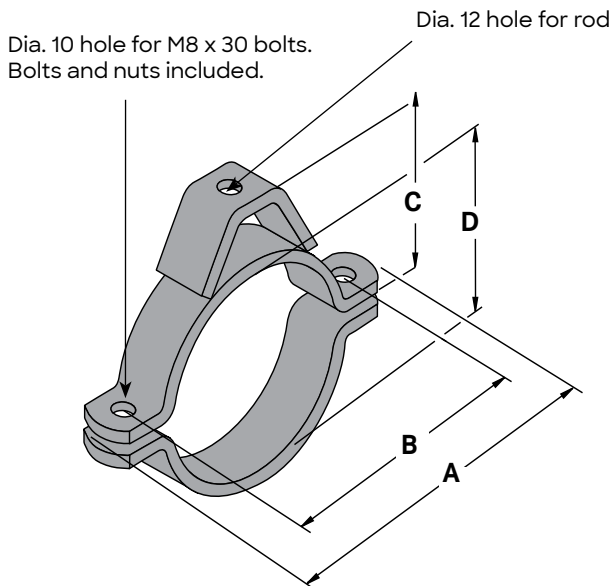

- Material: 20 x 3
- Working Load: 1.32 kN
- Safety Factor: 2.5
- Standard Finish: Heavy Duty Galvanised



Part No.	Dimensions				Kg
	D	A	B	C	
UN8-019	19	83	59	47	0.17
UN8-021	21	85	61	47	0.17
UN8-025	25	89	65	47	0.19
UN8-027	27	91	67	47	0.19
UN8-032	32	96	72	52	0.19
UN8-034	34	98	74	54	0.20
UN8-038	38	102	78	56	0.21
UN8-043	43	107	83	60	0.21
UN8-048	48	112	88	63	0.21
UN8-051	51	115	91	65	0.21
UN8-060	60	124	100	70	0.21
UN8-064	64	128	104	72	0.26
UN8-073	73	137	113	77	0.27
UN8-076	76	140	116	79	0.28
UN8-089	89	153	129	86	0.30
UN8-102	102	166	142	93	0.31
UN8-114	114	178	154	99	0.34
UN8-127	127	191	167	105	0.37
UN8-140	140	204	180	112	0.38
UN8-152	152	216	192	118	0.41
UN8-165	165	229	203	125	0.41

P2600 Uni-Cushion

- Shock absorption
- Protection from corrosion and abrasion
- Allowance for expansion and contraction
- Sound and vibration isolation
- Stability in use from -45oC to +175oC
- Flexible elastomer material
- Packaged in handy 7.6m dispenser pack

Part No.	W mm	T mm		
P2600	32	2.0	7.6m	1.7

See page 156 for cutting guide

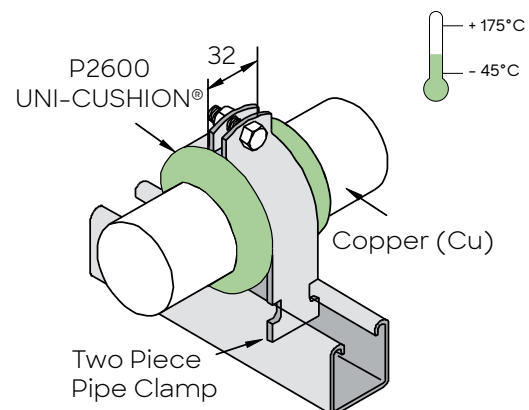

Pipe Supports - Light Duty

P2024 Pipe Supports

Part No	D mm	kg	Part No	D mm	kg
P2024	8	0.04	P2051	92	0.25
P2025	11	0.04	P2052	95	0.26
P2026	14	0.04	P2053	98	0.27
P2027	17	0.05	P2054	102	0.28
P2028	19	0.05	P2055	105	0.28
P2029	22	0.05	P2056	108	0.29
P2030	25	0.06	P2057	111	0.30
P2031	29	0.07	P2058	114	0.30
P2032	32	0.07	P2059	117	0.32
P2033	35	0.08	P2060	121	0.33
P2034	38	0.08	P2062	127	0.34
P2035	43	0.09	P2064	133	0.35
P2036	44	0.11	P2066	140	0.36
P2037	49	0.13	P2068	146	0.41
P2038	51	0.14	P2070	152	0.43
P2039	54	0.15	P2070-62	159	0.45
P2040	57	0.15	P2070-64	165	0.46
P2041	60	0.15	P2070-66	171	0.47
P2042	64	0.16	P2070-70	178	0.49
P2043	67	0.17	P2070-74	191	0.53
P2044	70	0.17	P2070-80	203	0.56
P2045	73	0.18	P2070-84	216	0.59
P2046	76	0.19	P2070-225	225	0.62
P2047	79	0.20	P2070-230	230	0.63
P2048	83	0.21	P2070-240	240	0.65
P2049	86	0.21	P2070-250	250	0.68
P2050	90	0.21	P2070-260	260	0.71

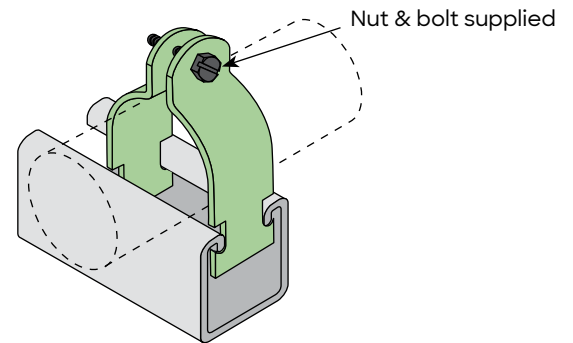

Also available in Heavy Duty Galvanised Finish.

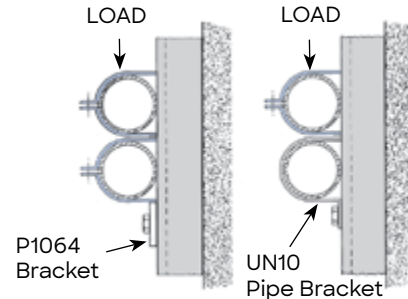

NOTE: When used in the application illustrated, it is recommended that the lower clamp be supported against possible slippage. Where P2024 series clamps are restraining pipework subject to vibration, the use of P2600 UNI-CUSHION® is recommended.

Standard Finish: Galvanised

P2600 Uni-Cushion® And Cutting Guide

- Shock absorption
- Protection from corrosion and abrasion
- Allowance for expansion and contraction
- Sound and vibration isolation
- Stability in use from -45°C to +175°C
- Flexible elastomer material
- Packaged in handy 7.6m dispenser pack

O.D. Size mm	Use with Clamp	UNI-CUSHION® Length mm	O.D. Size mm	Use with Clamp	UNI-CUSHION® Length in mm	O.D. Size mm	Use with Clamp	UNI-CUSHION® Length mm
6.4	P2025	22.2	69.9	P2045	222.3	133.4	P2065	412.8
9.5	P2026	27	73	P2046	235	136.5	P2066	419.1
12.7	P2027	38.1	76.2	P2047	241.3	139.7	P2067	431.8
15.9	P2028	54	79.4	P2048	254	142.9	P2068	444.5
19.1	P2029	57.2	82.6	P2049	266.7	146.1	P2069	450.9
22.2	P2030	76.2	85.7	P2050	273.1	149.2	P2070	463.6
25.4	P2031	82.6	88.9	P2051	279.4	155.6	P2070-62	482.6
28.6	P2032	92.1	92.1	P2052	285.8	161.9	P2070-64	501.7
31.8	P2033	101.6	95.3	P2053	292.1	168.3	P2070-66	520.7
34.9	P2034	114.3	98.4	P2054	298.5	174.6	P2070-70	539.8
38.1	P2035	123.8	101.6	P2055	304.8	187.3	P2070-74	577.9
41.3	P2036	133.4	104.8	P2056	317.5	190.5	P2070-80	590.6
44.5	P2037	139.7	108	P2057	330.2	193.7	P2070-84	596.9
47.6	P2038	152.4	111.1	P2058	342.9	196.9	P2070-225	609.6
50.8	P2039	165.1	114.3	P2059	355.6	200	P2070-230	622.3
54	P2040	171.5	117.5	P2060	362	203.2	P2070-240	628.7
57.2	P2041	184.2	120.7	P2061	374.7	206.4	P2070-250	635
60.3	P2042	190.5	123.8	P2062	381	209.6	P2070-260	647.7
63.5	P2043	203.2	127	P2063	393.7	212.7	P2083	660.4
66.7	P2044	209.6	130.2	P2064	406.4	215.9	P2084	666.8



Pipe Clamps - Light Duty

WOPF Standard Single Bolt Clip (Insulated)

Part No.	Dimensions				Working Load	kg
	ØD	A	L	W X T		
WOPFI	15 - 16	44	43	20 x 1.00	0.8kN	0.04
WOPFI	21 - 22	51	50	20 x 1.00	0.8kN	0.04
WOPFI	27 - 28	56	56	20 x 1.00	0.8kN	0.05
WOPFI	34 - 35	63	64	20 x 1.25	1.1kN	0.06
WOPFI	40 - 41	69	69	20 x 1.25	1.1kN	0.06
WOPFI	42 - 43	70	71	20 x 1.25	1.1kN	0.07
WOPFI	48 - 49	77	77	20 x 1.25	1.1kN	0.07
WOPFI	54 - 55	83	83	20 x 1.25	1.1kN	0.08
WOPFI	57 - 58	88	86	20 x 1.25	1.1kN	0.08
WOPFI	60 - 61	99	99	20 x 1.25	1.1kN	0.08

NOTE:

EPDM is rated from minus 50°C to 110°C
Sound insulation value on average 22db(A)

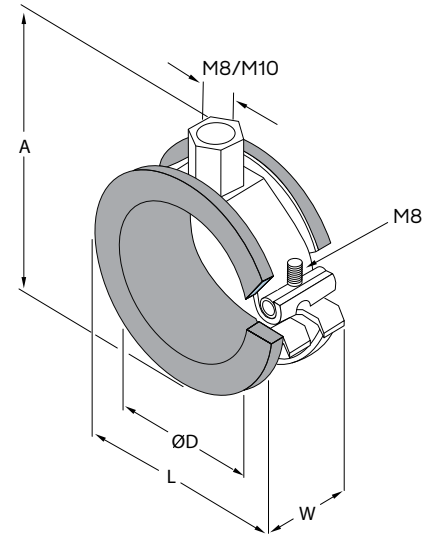

WOPF Perfect 2 Bolt Clip

Part No.	Dimensions				Working Load	kg
	ØD	A	L	W X T		
WOPF 21-25	21 - 25	42	46	20 x 2.00	0.8kN	0.08
WOPF 27-32	27 - 32	47	56	20 x 2.00	0.8kN	0.08
WOPF 33-38	33.5 - 38	55	61	20 x 2.00	0.8kN	0.09
WOPF 42-46	42.5 - 46	64	68	20 x 2.00	0.8kN	0.10
WOPF 48-53	48.5 - 53	70	77	20 x 2.00	0.8kN	0.10
WOPF 60-65	60.5 - 65	82	89	20 x 2.00	0.8kN	0.12
WOPF 73-77	73 - 77	103	107	25 x 2.50	1.9kN	0.18
WOPF 84-90	84 - 90	105	121	25 x 2.50	1.9kN	0.20
WOPF 109-114	109 - 114	140	145	25 x 2.50	1.9kN	0.23

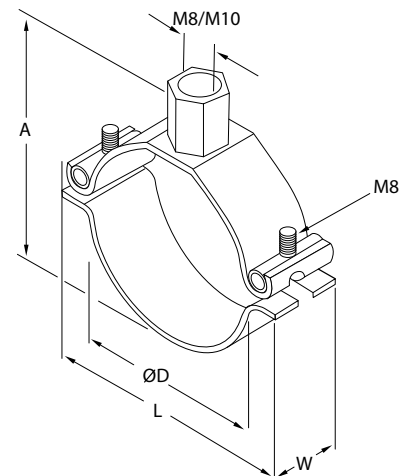

WOPF Standard 2 Bolt Clip (Insulated)

Part No.	Dimensions				Working Load	kg
	ØD	A	L	W X T		
WOPFI	67 - 72	94	116	25 x 1.50	1.9kN	0.15
WOPFI	72 - 78	100	123	25 x 1.50	1.9kN	0.16
WOPFI	84 - 89	108	134	25 x 2.00	2.3kN	0.20
WOPFI	109 - 114	136	162	25 x 2.00	2.3kN	0.24

NOTE:

EPDM is rated from minus 50°C to 110°C
Sound insulation value on average 22db(A)

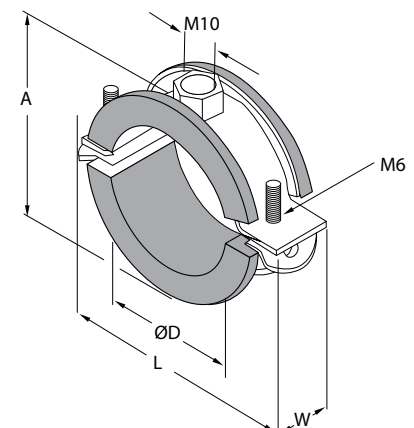

Pipe Supports - Light Duty



Split Clips

Part No.	Dimensions			kg
	ØD	L	W X T	
SC15Z	21	74	20 x 3.00	0.10
SC20Z	27	83	20 x 3.00	0.11
SC25Z	33.5	90	20 x 3.00	0.12
SC32Z	42.5	100	20 x 3.00	0.13
SC40Z	48.5	105	20 x 3.00	0.14
SC50Z	60.5	118	20 x 3.00	0.15
SC65Z	76	136	20 x 3.00	0.18
SC80Z	89	160	20 x 3.00	0.19
SC100Z	114	178	25 x 3.00	0.29
SC150Z	165	230	25 x 3.00	0.39

Welded 10mm Threaded Boss standard

Part No.	Dimensions			kg
	ØD	L	W X T	
SC65SP - Z	76	136	25 x 4.00	0.23
SC80SP - Z	89	160	25 x 4.00	0.25
SC100SP - Z	115	178	25 x 4.00	0.50

Welded 12mm Threaded Boss

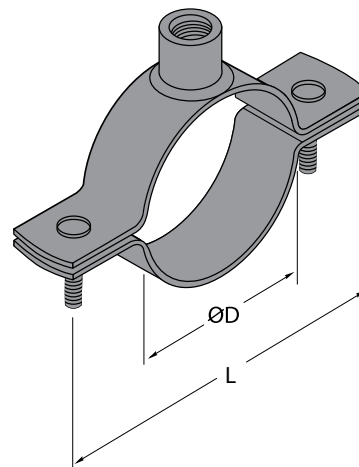

Pipe Supports – Medium Duty

UN14 – “U” Bolts

Standard Finish: Galvanised

Part No	ØD	H mm	H1 mm	ØC mm	kg
UN14-021	21	65	50	10	0.09
UN14-027	27	77	50	10	0.10
UN14-034	34	85	50	10	0.12
UN14-043	43	93	50	10	0.13
UN14-048	48	100	50	10	0.14
UN14-051	51	103	50	10	0.14
UN14-060	60	110	50	10	0.16
UN14-076	76	127	50	12	0.28
UN14-089	89	140	50	12	0.30
UN14-102	102	152	50	12	0.35
UN14-114	114	165	50	12	0.38
UN14-140	140	190	50	12	0.40
UN14-165	165	215	50	12	0.44
UN14-168	168	220	50	12	0.48
UN14-219	219	295	75	16	1.13
UN14-273	273	370	100	20	2.20
UN14-324	324	420	100	20	2.52
UN14-356	356	455	100	20	2.74
UN14-406	406	505	100	20	3.05
UN14-457	457	555	100	24	4.87
UN14-508	508	605	100	24	5.32
UN14-610	610	710	100	24	6.28

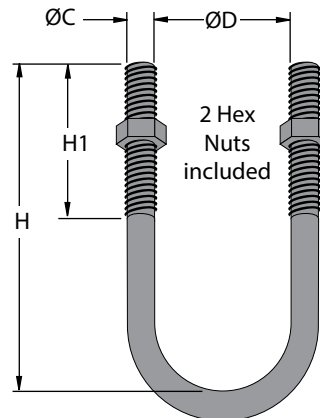

UN15 – Medium Duty Saddle Clamp

- Safety Factor: 2.5
- Standard Finish: Galvanised

Part No.	D	L1	L2	WxT	Working Load	kg
UN15-021	21	75	115	40x5	2.46kN	0.14
UN15-027	27	81	121	40x5	2.46kN	0.20
UN15-034	34	88	128	40x5	2.46kN	0.28
UN15-043	43	97	137	40x5	2.46kN	0.34
UN15-048	48	102	142	40x5	2.46kN	0.34
UN15-051	51	105	145	40x5	2.46kN	0.34
UN15-060	60	114	154	40x5	2.46kN	0.40
UN15-076	76	130	170	40x5	2.46kN	0.46
UN15-089	89	143	183	40x5	2.46kN	0.54
UN15-102	102	156	196	40x5	2.46kN	0.58
UN15-114	114	170	210	40x6	3.57kN	0.65
UN15-140	140	196	236	40x6	3.57kN	0.75
UN15-152	152	208	248	50x6	4.44kN	1.17
UN15-165	165	221	261	50x6	4.44kN	1.25
UN15-168	168	224	264	50x6	4.44kN	1.27
UN15-203	203	259	299	50x6	4.44kN	1.48
UN15-219	219	275	315	50x6	4.44kN	1.58

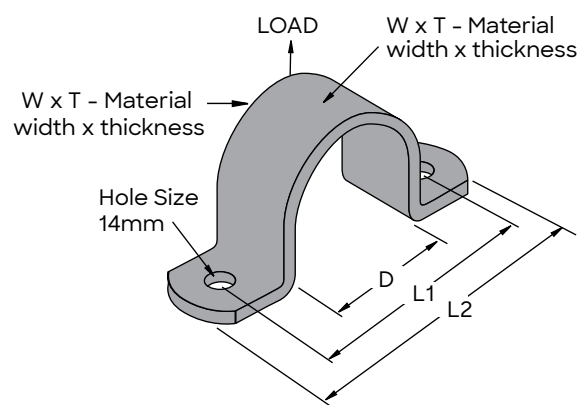

Pipe Supports - Medium Duty

UN16 - Medium Duty Two-Piece Pipe Clamp

- Working Load: 7.20 kN
- Safety Factor: 2.5
- Standard Finish: Galvanised

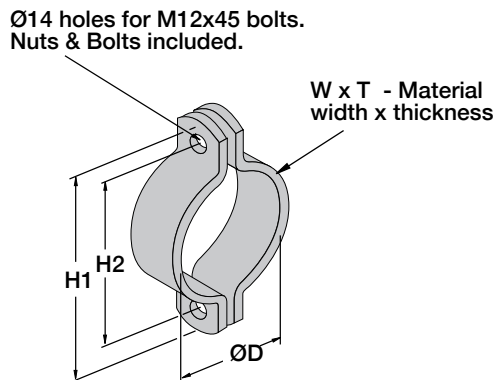

Part No.	ØD	H1	H2	WxT	kg
UN16-060	60	154	114	40x5	0.72
UN16-076	76	170	130	40x5	0.84
UN16-089	89	183	143	40x5	1.02
UN16-102	102	196	156	40x5	1.12
UN16-114	114	210	170	40x6	1.17
UN16-127	127	221	181	40x6	1.25
UN16-140	140	234	194	40x6	1.31
UN16-152	152	246	206	40x6	1.38
UN16-165	165	259	219	40x6	1.46
UN16-178	178	272	232	40x6	1.54
UN16-190	190	284	244	40x6	1.64
UN16-203	203	297	257	40x6	1.69
UN16-219	219	313	273	40x6	1.78
UN16-230	230	324	284	40x6	1.84
UN16-240	240	334	294	40x6	1.92
UN16-250	250	344	304	40x6	2.00
UN16-273	273	367	327	40x6	2.18
UN16-324	324	418	378	40x6	2.59

UN18 - Medium Duty Two-Piece Pipe Clamp

- Safety Factor: 2.5
- Standard Finish: Galvanised

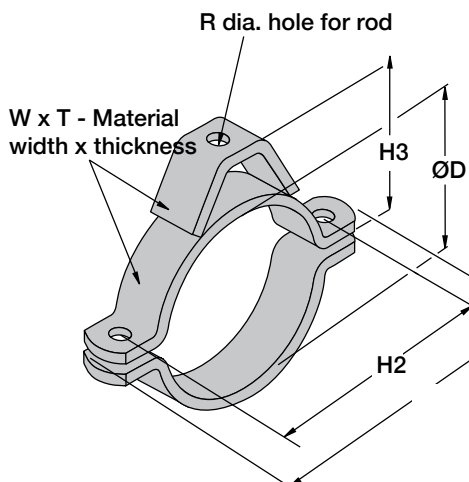

Part No.	ØD	H1	H2	H3	R	WxT	Working Load	kg
UN18-060	60	154	114	75	14	40x5	1.77kN	0.72
UN18-076	76	170	130	88	14	40x5	3.53kN	0.84
UN18-089	89	183	143	99	14	40x5	3.53kN	1.02
UN18-102	102	196	156	108	14	40x5	3.53kN	1.12
UN18-114	114	210	170	116	14	40x6	3.53kN	1.17
UN18-127	127	221	181	124	14	40x6	4.51kN	1.25
UN18-140	140	234	194	132	14	40x6	4.51kN	1.31
UN18-152	152	246	206	139	14	40x6	4.51kN	1.38
UN18-165	165	259	219	146	14	40x6	4.51kN	1.46
UN18-178	178	272	232	153	14	40x6	4.51kN	1.54
UN18-203	203	297	257	167	14	40x6	4.51kN	1.69
UN18-219	219	313	273	175	14	40x6	4.51kN	1.78
UN18-230	230	324	284	181	14	40x6	4.51kN	1.84

All sizes have a 14mm dia. hole to suit M12 x 45 bolts. Nuts and bolts included.

Pipe Supports – Medium Duty

UN20 – Medium Duty Three Bolt Pipe Clamp

- Safety Factor: 2.5
- Standard Finish: Galvanised

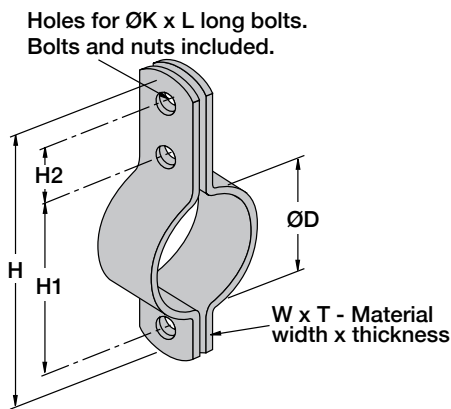

Part No	ØD	H	H1	H2	W x T	ØK x L	Working Load	kg
UN20-021	21	159	71	48	25x5	M10x30	5.02kN	0.34
UN20-027	27	165	77	48	25x5	M10x30	5.02kN	0.36
UN20-034	34	176	88	48	40x6	M12x45	7.24kN	0.58
UN20-043	43	185	97	48	40x6	M12x45	7.24kN	0.62
UN20-048	48	190	102	48	40x6	M12x45	7.24kN	0.64
UN20-060	60	210	122	48	50x6	M16x50	11.52kN	1.57
UN20-076	76	226	138	48	50x6	M16x50	11.52kN	1.69
UN20-089	89	239	151	48	50x6	M16x50	11.52kN	1.79
UN20-114	114	339	200	75	75x10	M20x60	20.10kN	5.17
UN20-140	140	365	226	75	75x10	M20x60	20.10kN	5.65
UN20-165	165	390	251	75	75x10	M20x60	20.10kN	6.13
UN20-219	219	444	305	75	75x10	M24x60	28.80kN	7.83
UN20-273	273	498	359	75	75x10	M24x60	28.80kN	8.83
UN20-324	324	549	410	75	75x10	M24x60	28.80kN	9.77
UN20-356	356	628	464	100	75x16	M30x80	45.18kN	17.04
UN20-406	406	678	514	100	75x16	M30x80	45.18kN	18.5
UN20-457	457	763	587	100	75x20	M36x100	45.18kN	24.95
UN20-508	508	814	638	100	75x20	M36x100	45.18kN	26.83
UN20-610	610	916	740	100	75x20	M36x100	45.18kN	30.61

UN21 – Medium Duty Vertical Pipe Clamp

- Safety Factor: 2.5
- Standard Finish: Galvanised

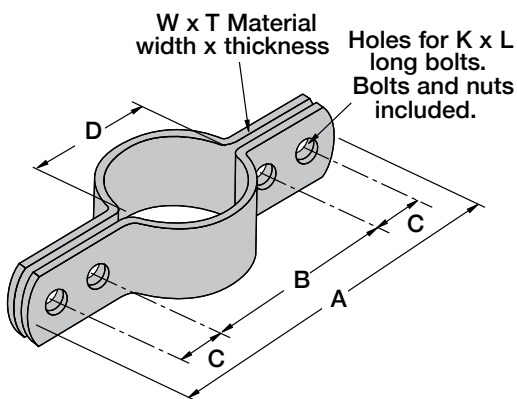

Part No.	Dimensions						Load Capacity	Mass kg
	D	A	B	C	W x T	K x L		
UN21-21	21	207	71	48	32 x 5	M10 x 35	1.11kN	0.75
UN21-27	27	213	77	48	32 x 5	M10 x 35	1.11kN	0.77
UN21-34	34	220	84	48	32 x 5	M10 x 35	1.11kN	0.80
UN21-43	43	229	93	48	32 x 5	M10 x 35	1.11kN	0.84
UN21-48	48	238	102	48	40 x 6	M12 x 40	1.80kN	1.19
UN21-60	60	250	114	48	40 x 6	M12 x 40	1.80kN	1.26
UN21-76	76	266	130	48	50 x 6	M12 x 40	2.22kN	1.63
UN21-89	89	278	143	48	50 x 6	M12 x 40	2.22kN	1.73
UN21-114	114	304	168	48	50 x 6	M12 x 40	2.22kN	1.91
UN21-140	140	330	194	48	50 x 6	M12 x 40	2.22kN	2.11
UN21-165	165	468	254	75	75 x 10	M16 x 60	9.71kN	6.72
UN21-219	219	519	305	75	75 x 10	M16 x 60	9.71kN	7.65
UN21-273	273	573	359	75	75 x 10	M16 x 60	9.71kN	8.65
UN21-324	324	624	410	75	75 x 10	M16 x 60	10.79kN	9.83
UN21-356	356	662	448	75	75 x 10	M16 x 60	10.79kN	10.17
UN21-406	406	712	498	75	90 x 12	M20 x 75	11.77kN	15.87
UN21-457	457	779	565	75	90 x 12	M20 x 75	11.77kN	17.23
UN21-508	508	830	616	75	90 x 12	M20 x 75	11.77kN	18.58

Pipe Supports – Heavy Duty and Accessories

UN30 – Heavy Duty Saddle Clamp

- Safety Factor: 2.5
- Standard Finish: Galvanised

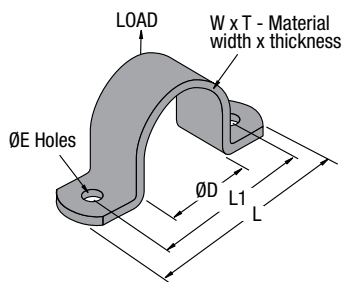

Part No	ØD	L1	L	ØE	W x T	Working Load	kg
UN30-168	168	260	324	22	75x10	10.87kN	3.22
UN30-219	219	310	375	22	75x10	10.87kN	4.21
UN30-273	273	364	428	22	75x10	10.87kN	4.81
UN30-324	324	415	479	22	75x10	10.87kN	5.80
UN30-356	356	447	511	22	75x10	10.87kN	6.10
UN30-406	406	497	561	26	90x12	18.78kN	9.90
UN30-457	457	548	612	26	90x12	18.78kN	11.00
UN30-508	508	600	663	26	90x12	18.78kN	12.12

UN31 – Heavy Duty Two-Piece Pipe Clamp

- Safety Factor: 2.5
- Standard Finish: Galvanised

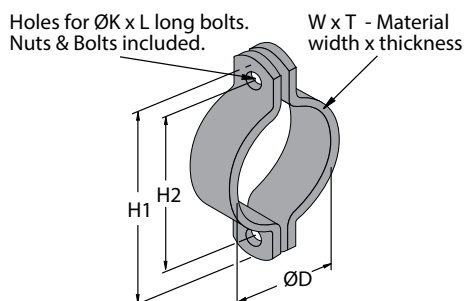

Part No	ØD	H1	H2	W x T	ØK x L	Working Load	kg
UN31-168	168	318	254	75x10	M20 x 60	20.10kN	5.00
UN31-219	219	369	305	75x10	M20 x 60	20.10kN	6.00
UN31-273	273	423	359	75x10	M20 x 60	20.10kN	7.00
UN31-324	324	474	410	75x10	M20 x 60	20.10kN	8.00
UN31-356	356	512	448	75x12	M24 x 75	28.93kN	11.00
UN31-406	406	562	498	75x12	M24 x 75	28.93kN	12.00
UN31-457	457	629	565	75x16	M30 x 90	45.18kN	19.00
UN31-508	508	680	616	75x16	M30 x 90	45.18kN	20.00
UN31-610	610	782	718	75x16	M30 x 90	45.18kN	23.00

UN35 – Eye Nuts [HG]

Non Stock Item.
Made to Order

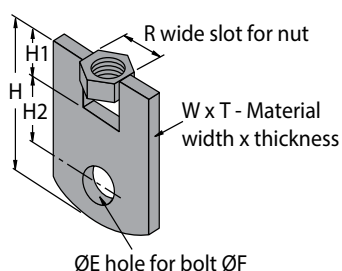

Part No	H	H1	H2	ØE	ØF	R	W x T	Working Load	kg
UN35-12-M10	70	20	30	14	12	18	40 x 6	3.60 kN	0.13
UN35-16-M12	80	25	30	18	16	20	75 x 10	5.80 kN	0.47
UN35-20-M16	90	30	35	22	20	25	90 x 12	9.72 kN	0.76
UN35-24-M20	90	30	35	26	24	31	90 x 12	14.48 kN	0.76
UN35-30-M24	120	35	50	32	30	37	100 x 20	21.84 kN	1.88
UN35-36-M30	140	40	60	38	36	47	130 x 20	32.56 kN	2.86

Pipe Supports - Heavy Duty and Accessories

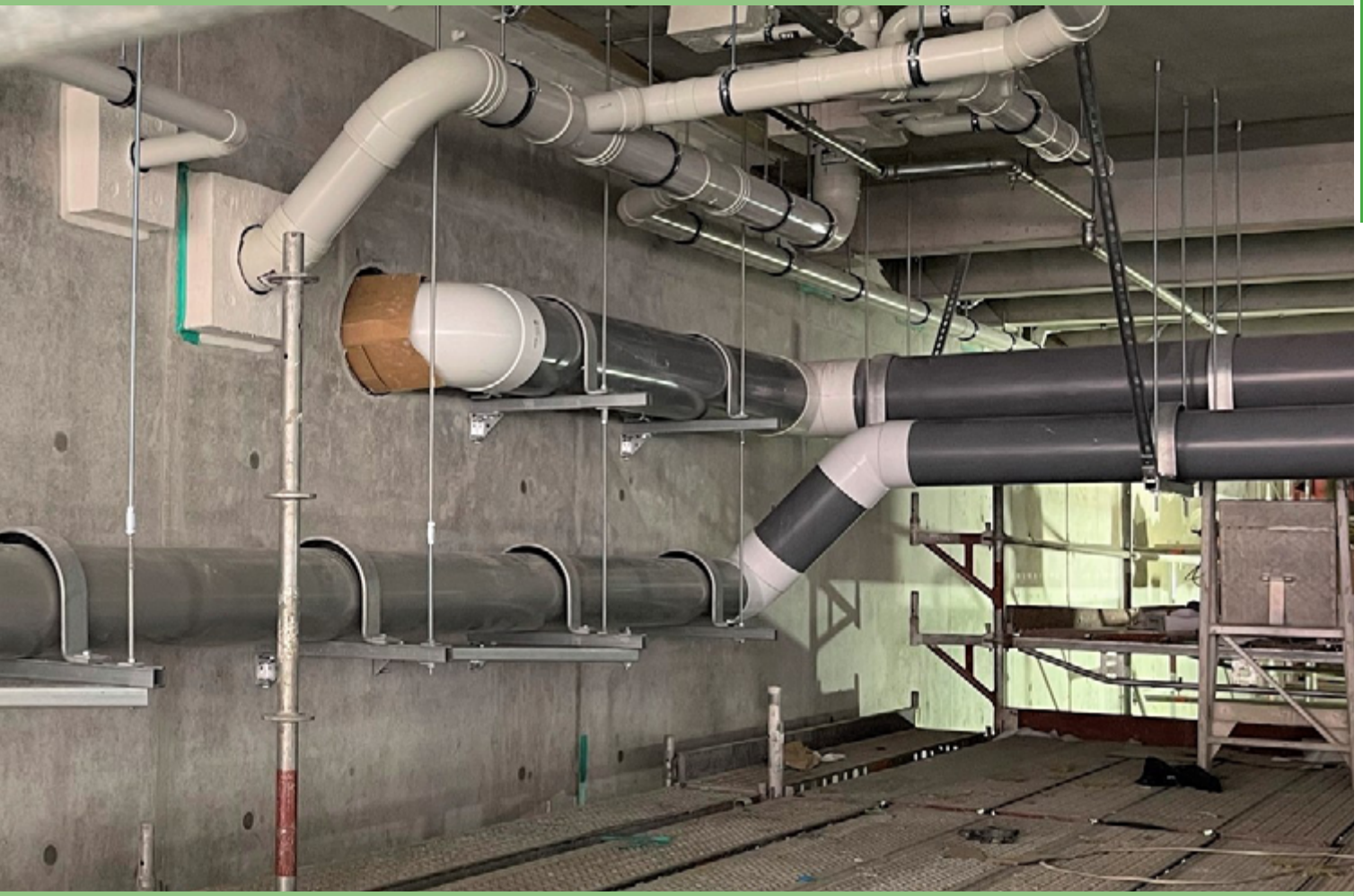

UN37 - Spherical Washer for UN38 [MI]

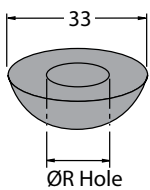

Part No	ØR	Kg	
UN37-06	08	0.10	100
UN37-10	12	0.09	100
UN37-12	14	0.09	100
UN37-16	18	0.07	50

UN38 - Swivel Cage [HG]

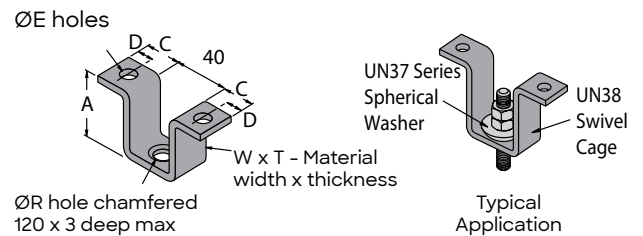

Part No	A	C	D	ØE	ØR	W x T	Kg	
UN38-06	65	31	12	10	08	25x5	0.20	25
UN38-10	65	31	12	10	12	25x5	0.20	25
UN38-12	65	47	20	14	14	40x6	0.35	20
UN38-16	100	47	20	14	18	50x6	0.52	10

Pipe Supports - Accessories and Beam Attachments

UNCL - Clevis Hanger [HG]

Part No	L	L1	H	ØE	ØR	WxT	Working Load	kg
UNCL-10	35	15	70	10	12	25 x 5	1.75 kN	0.08
UNCL-12	45	20	75	14	14	40 x 5	2.17 kN	0.20
UNCL-16	48	20	100	14	18	50 x 5	2.55 kN	0.32
UNCL-20	62	32	112	22	22	75 x 10	9.08 kN	1.08

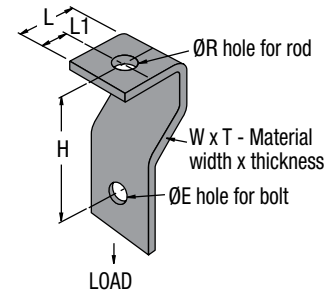

UNLP - Link Plate [HG]

Part No	H	H1	ØE	WxT	kg
UNLP08	64	36	10	25 x 3	0.03
UNLP10	64	36	12	25 x 5	0.05
UNLP12	120	80	14	40 x 6	0.23
UNLP16	120	80	18	50 x 6	0.28
UNLP20	190	126	22	75 x 10	1.11

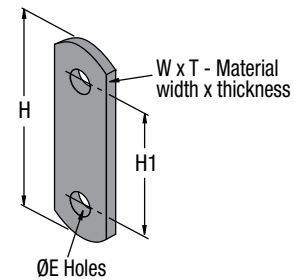

Universal Hinge (UH10Z)

Features & Benefits

- Can be fixed directly to roof sections, or attached to Atkore Unistrut channel mounted across purlins/beams.
- Accepts all M10 ZP threaded products (including threaded rod)
- Allowable load 828kg (per Universal Hinge Mount)
- Full adjustable through 135 degrees to suit any mounting application



Pipe Supports – Accessories and Beam attachments

EF1200A – Rod Hanger Mounting Plate

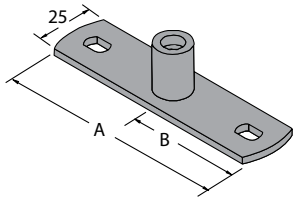

EF1200A
Base Plate

Part No	Description	Thread Size	Dim "A"	Dim "B"
EF1200A-M10	EF1200A-M10 ROD HANGER CENTRAL MOUNT ZP	M10	100mm	50mm
EF1200A-M12	EF1200A-M12 ROD HANGER CENTRAL MOUNT ZP	M12	100mm	50mm
BP10Z	BASE PLATE 10MM THREAD	M10		
BP10-SPZ	BASE PLATE 10MM 45°	M10		

Other finishes available. Made to order and minimum order quantities may apply.

EF1600 – Flange Clamp

Standard Finishes: Z.P

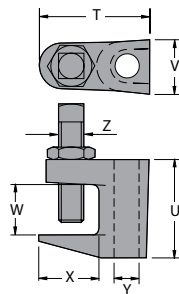
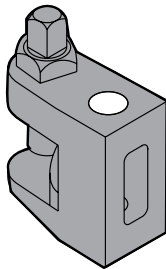

The simplest, quickest and most cost-effective method of suspending building services from steel beams and suitable for use with parallel or tapered flange beams, the EF1600 is supplied with the back hole drilled to accept a threaded rod. The EF1600 uses a grade 8.8 cup point setscrew to provide a maximum bite into steelwork and maximum load performance.

Product Code	Drop Rod	Tensile Loads Safe Working Load 4:1(kN)	Setscrew Torque (Nm)	Lockout Torque (Nm)	T	U	V	W	X	Y	Z
EF1600-10	M10	2.4	8	22	45	40	22	19	22	11	10
EF1600-12	M12	3.1	8	22	50	46	25	23	28	13	10



Concrete Vertigo
M8/M10/M12



Wood Vertigo
M10 25mm/50mm



Steel Vertigo
M10



Purlin Side Hanger
with backing nut
M10

Engineering Data - Mass Charts

Copper Tube

Nom. Size	Actual Size O.D. (AUS)	Actual Size O.D. (NZ)	Mass of Pipe kg/m	Mass of Pipe filled with water kg/m
15 x 0.9	12.7	14.7	0.30	0.39
18 x 1.0	15.9		0.43	0.58
20 x 1.0	19.0	21.0	0.52	0.75
25 x 1.2	25.4	27.4	0.83	1.25
32 x 1.2	31.8	34.1	1.05	1.72
40 x 1.2	38.1	40.6	1.27	2.27
45 x 1.2	44.5		1.48	2.87
50 x 1.2	51.2	53.3	1.70	3.57
65 x 1.2	63.5	65.0	2.14	5.07
80 x 1.6	76.2	79.4	3.42	7.60
90 x 1.6	88.9	92.5	4.00	9.76
100 x 1.6	101.6	105.6	4.58	12.18
125 x 1.6	127.0	130.2	5.74	17.77
150 x 2.0	152.4	158.0	8.58	25.86
175 x 2.0	177.8		10.03	33.74
200 x 2.0	203.2		11.48	42.63
225 x 2.6	228.6		16.77	56.94

Pressure Pipe

API Std Wt - ANSI Sch 40 (up to 250 NS)

Nom. Pipe Size	Actual Size O.D. x Wall	Mass of Pipe kg/m	Mass of Pipe filled with water kg/m
8	13.7 x 2.24	0.62	0.69
10	17.1 x 2.31	0.85	0.97
15	21.3 x 2.77	1.27	1.47
20	26.7 x 2.87	1.68	2.11
25	33.4 x 3.38	2.50	3.06
32	42.2 x 3.56	3.38	4.35
40	48.3 x 3.68	4.05	5.37
50	60.3 x 3.91	5.44	7.60
65	73.0 x 5.16	8.62	11.71
80	88.9 x 5.49	11.29	16.06
90	101.6 x 5.74	13.57	19.95
100	114.3 x 6.02	16.07	24.28
125	141.3 x 6.55	21.78	34.69
150	168.3 x 7.11	28.26	46.91
200	219.1 x 8.18	42.53	74.81
250	273.0 x 9.27	60.29	111.14
300	323.9 x 9.53	73.82	146.81
350	355.6 x 9.53	81.28	170.23
400	406.4 x 9.53	93.21	211.05
450	457.0 x 9.53	105.14	255.75
500	508.0 x 9.53	117.07	304.85
600	609.6 x 9.53	140.94	414.85

Pressure Pipe

ANSI Sch 80 - API XS (up to 200 NS)

Nom. Pipe Size	Actual Size O.D. x Wall	Mass of Pipe kg/m	Mass of Pipe filled with water kg/m
8	13.7 x 3.02	0.80	0.85
10	17.1 x 3.20	1.10	1.19
15	21.3 x 3.73	1.62	1.77
20	26.7 x 3.91	2.19	2.47
25	33.4 x 4.55	3.23	3.69
32	42.2 x 4.85	4.47	5.30
40	48.3 x 5.08	5.41	6.55
50	60.3 x 5.54	7.48	9.38
65	73.0 x 7.01	11.41	14.4
80	88.9 x 7.62	15.27	19.53
90	101.6 x 8.08	18.63	24.36
100	114.3 x 8.56	22.37	29.73
125	141.3 x 9.53	30.95	42.69
150	168.3 x 10.97	42.56	59.38
200	219.1 x 12.70	64.63	94.10
250	273.0 x 12.70	81.54	129.70
300	323.9 x 12.70	97.44	167.4
350	355.6 x 12.70	107.38	193.00
400	406.4 x 12.70	123.29	234.30
450	457.0 x 12.70	139.19	285.50
500	508.0 x 12.70	155.10	337.00
600	609.6 x 12.70	186.92	455.00

Galvanised Pipe

Nom. Size	Actual Size O.D. x Wall	Mass of Pipe kg/m	Mass of Pipe filled with water kg/m
8 N.B Med.	13.5 x 2.3	0.68	0.74
10 N.B Med.	17.2 x 2.3	0.89	1.01
15 N.B Med.	21.3 x 2.6	1.27	1.47
20 N.B Med.	26.9 x 2.6	1.65	2.02
25 N.B Med.	33.7 x 3.2	2.52	3.11
32 N.B Med.	42.4 x 3.2	3.24	4.26
40 N.B Med.	48.3 x 3.2	3.73	5.11
50 N.B Med.	60.3 x 3.6	5.24	7.46
65 N.B Med.	76.1 x 3.6	6.69	10.42
80 N.B Med.	88.9 x 4.0	8.68	13.82
100 N.B Med.	114.3 x 4.5	12.40	21.11
125 N.B Med.	139.7 x 4.9	16.50	29.75
150 N.B Med.	165.1 x 4.9	19.60	38.55



Engineering Data - Mass Charts

PVC Pressure Pipe - Class 15

Nom. Size	Actual Size O.D. x Wall	Mass of Pipe kg/m	Mass of Pipe filled with water kg/m
15	21.3 x 1.5	0.14	0.40
20	26.7 x 1.9	0.22	0.61
25	33.5 x 2.3	0.33	0.99
32	42.2 x 2.9	0.54	1.58
40	48.2 x 3.3	0.69	2.05
50	60.3 x 4.1	1.07	3.20
65	75.3 x 5.1	1.66	5.00
80	88.9 x 6.1	2.31	6.93
100	114.3 x 7.7	3.83	11.51
125	140.2 x 9.4	5.76	17.34
150	168.2 x 11.3	8.28	24.93
200	219.1 x 14.8	14.12	42.32

PVC Pressure Pipe - Class 6

Nom. Size	Actual Size O.D. x Wall	Mass of Pipe kg/m	Mass of Pipe filled with water kg/m
40	48.2 x 1.5	0.31	1.91
50	60.3 x 1.8	0.48	3.00
65	75.3 x 2.2	0.75	4.70
80	88.9 x 2.6	1.03	6.53
100	114.3 x 3.2	1.70	10.84
125	140.2 x 4.0	2.55	16.28
150	168.2 x 4.8	3.65	23.41
200	219.1 x 6.2	6.19	39.75

Cast Iron Pipes - Class K9

Nom. Size	Actual Size O.D. x Wall	Mass of Pipe kg/m	Pipe and Water kg/m	Concrete Lining Thickness	Mass of Lined Pipe kg/m	Mass of Lined Pipe and Water kg/m
80	95.5 x 6.0	12.36	17.84	6.0	15.64	19.66
100	121.9 x 6.1	16.55	26.00	6.0	21.09	28.59
150	177.3 x 6.3	25.09	46.39	6.0	31.82	50.13
200	232.2 x 6.4	34.18	71.89	8.0	46.18	78.67
225	259.1 x 6.6	39.45	86.94	8.0	52.91	94.42
250	286.0 x 6.8	44.73	103.00	8.0	60.00	111.63
300	345.4 x 7.2	57.09	143.24	10.0	81.45	157.42
375	426.2 x 7.9	79.27	211.55	10.0	109.45	229.15
400	507.0 x 8.6	107.82	290.24	10.0	138.73	312.08
500	560.3 x 9.0	117.82	347.95	10.0	158.91	373.16





Allied Tube & Conduit • AFC Cable Systems • Heritage Plastics • Unistrut
Unistrut Construction • United Poly Systems • Calbrite • Calbond • Cii • US Tray
Power-Strut • Calconduit • Razor Ribbon • Calpipe Security • Vergokan • Marco
Columbia-MBF • Eastern Wire + Conduit • ACS/Uni-Fab • Sasco Strut • Kaf-Tech
Cope • FRE Composites • Queen City Plastics • Four Star Industries • Flexicon

Atkore Unistrut New Zealand

Auckland (head office)

6 Arthur Brown Place
Mt Wellington
Auckland
TEL / (09) 573 2490

Wellington

54 Hutt Road
Petone
Wellington
TEL / (04) 913 8500

Hamilton

12-14 Kaimiro Street
Pukete Industrial Estate
Hamilton
TEL / (07) 958 7195

Christchurch

15 Lunns Road
Middleton
Christchurch 8024
TEL / (03) 343 6433

www.atkore.com/unistrut

linkedin.com/company/atkoreunistrutnz